

LED Flood Light

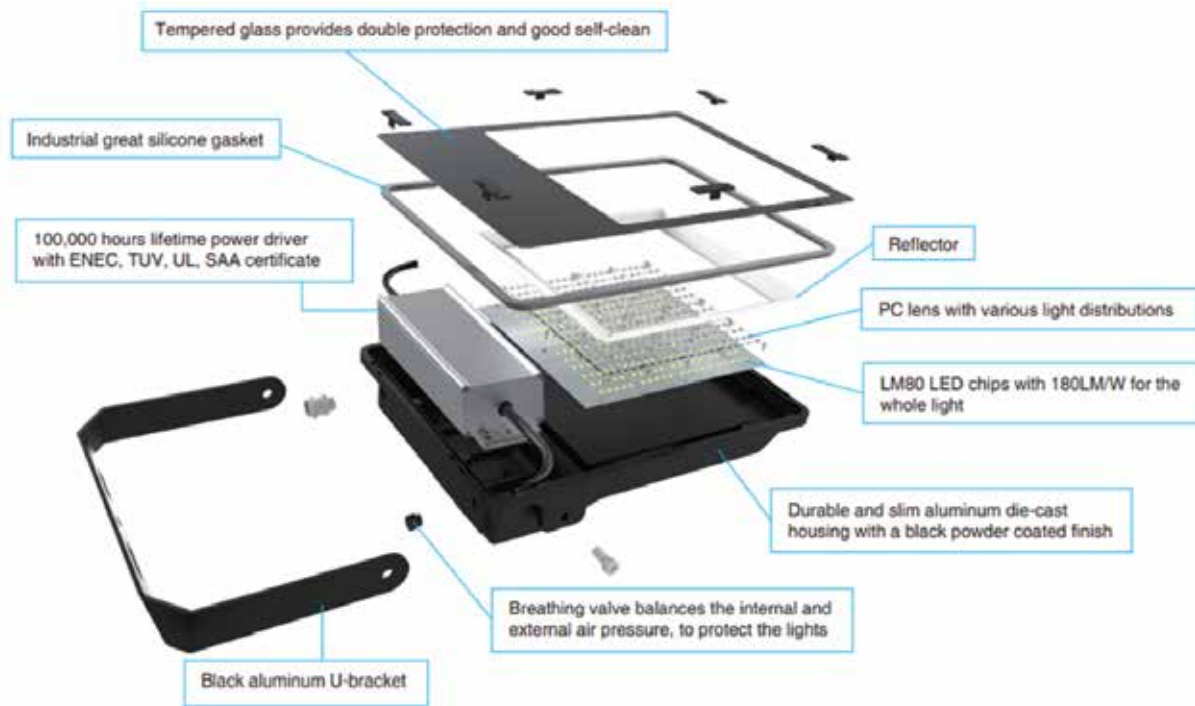

SLNo.	Model No.	Power(Watt)	Voltage	Efficacy	Total Lumen	Beam Angle	LED Quantity	Model
01	ARFT-T37-30W	30 W	AC100-277V 50-60Hz	140±10	4200±300	30°/60°/90° 90°/120° 40°/130° Type 2, Type 3, Type 4/ T1-VS, T2-M, T2-s, T3-M	56 PCS EMC3030	>70
02	ARFT-T37-50W	50 W		140±10	7000±500		56 PCS EMC3030	
03	ARFT-T37-80W	80 W		140±10	11200±800		126 PCS EMC3030	
04	ARFT-T37-100W	100 W		140±10	14000±1000		126 PCS EMC3030	
05	ARFT-T37-120W	120 W		140±10	16800±1200		126 PCS EMC3030	
06	ARFT-T37-150W	150 W		140±10	21000±1500		224 PCS EMC3030	
07	ARFT-T37-200W	200 W		140±10	28000±2000		224 PCS EMC3030	
08	ARFT-T37-240W	240 W		140±10	33600±2400		350 PCS EMC3030	
09	ARFT-T37-240W	300 W		140±10	42000±3000		350 PCS EMC3030	

Features:

- System Light Efficacy 160-165 LPW
- Ultra Bright, Up to 192,000Lm
- Lumen Maintenance: L70>150,000 Hours (Calculated Using Tm-21 Calculator)
- Flexible, Modular Design & Multiple Choice of Optical Lenses & Easy Installation & Maintenance
- Input Voltage 100-277 VAC (347/480 VAC Optional) Dimming Optional
- IK10 rated for all outdoor conditions
- Operating & Storing Temperature: -30 to 50°C (-22 to 131°F) & 40 to 80°C (-40 to 176°F)
- 5 Years warranty

